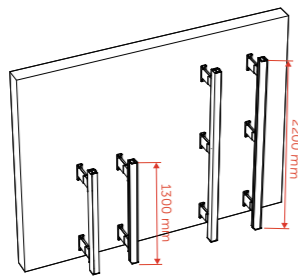

Number of brackets per rail:

- 130 cm rails: A minimum of 2 brackets per rail
- 220 cm rails: A minimum of 3 brackets per rail

Select the correct amount of brackets based on guide rail size before starting the assembly of zip screen.

NOTE! Assemble the brackets 10 cm inward on the rail at both the top and bottom. If multiple brackets are used, they should be evenly spaced to ensure the load is distributed evenly.

PARTS LIST

Nr.	Description	Illustration	Qty.
1	Slide rail		2
2	Upper bracket		2
3	Steel washer		4
4	Spring washer		4
5	Nut cap		4
6	Lower bracket		2
M	Wall screw (concrete)		4
N	Expanded colloid		4
H1	Wall screw (wood)		8
H2	Wall screw (Metal)		8
P	Steel washer		4
O	Spring washer		4
J	Washer		4
R	Fixing screw		4

Scan the QR code to read the manual online.

ASSEMBLE BRACKET

Before Installation: Measure and mark where the brackets should be placed before fastening them. Also remember to note the serial number on the motor cassette, located on the back, for future reference in case you need to contact our support team. Install the brackets and ensure they are securely anchored to the wall. The brackets must be positioned so they do not interfere with anything around the window or door.

STEP 1

Slide the upper bracket into the guide rail from the top.

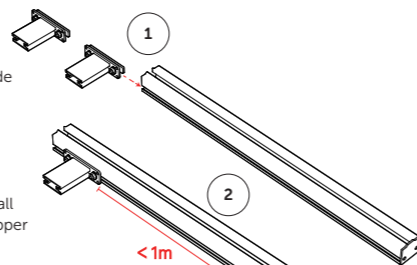
STEP 2

Adjust the spacing between the upper brackets according to the wall condition. The distance between upper brackets must not exceed 1 meter.

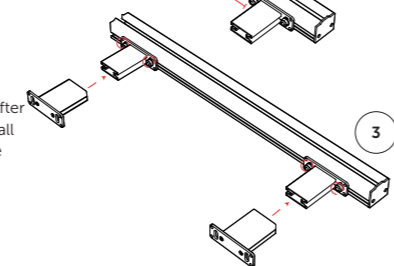

STEP 3

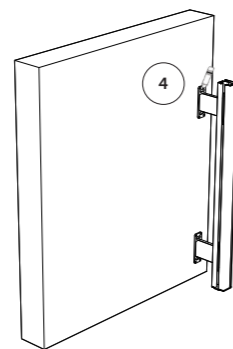
After tightening the screws on the upper brackets, insert the lower brackets into the upper brackets. After mounting the bottom bracket, install the remaining brackets in the same way.

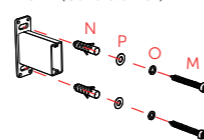

STEP 4

Determine the installation position of the guide rails around the window/door. Hold the guide rail vertically against the wall. Select suitable fixing screws according to the wall type. Use a marker pen to mark the drilling positions through the mounting holes.

Plan A (Concrete Wall)

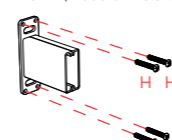

Plan B (Wood or Metal Surface)

STEP 5

Screw it in place and drill if necessary.

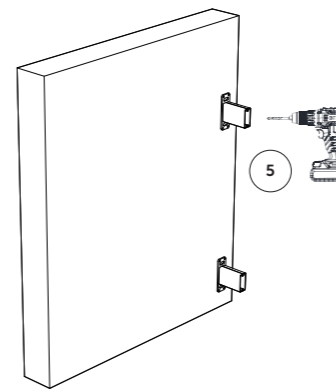
STEP 6

Adjust the position of the upper bracket using the screws. Insert it into the lower bracket and tighten the screws securely.

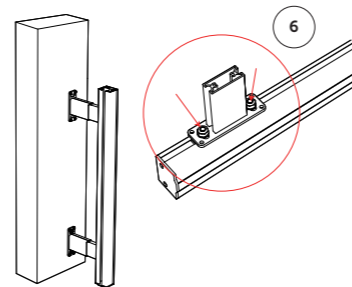
STEP 7

Use the spacer template (K) to determine the correct distance between the tops of the guide rail housings (included with the zip motor). Mark the mounting holes for the second guide rail using a marker pen. Install the second guide rail following the same steps as the first guide rail.

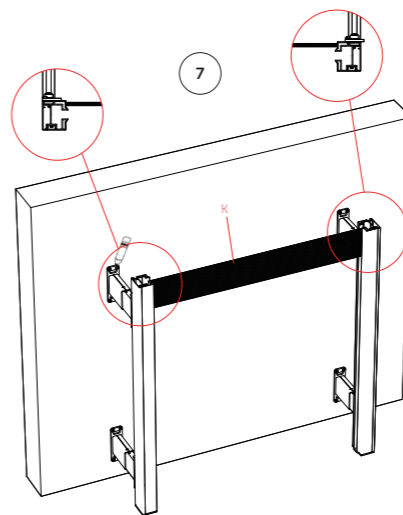
STEP 8

IMPORTANT! Use a spirit level and ensure that both guide rails are plumb and level before placing the motor cassette onto the rails. Adjust the distance between the guide rail and the wall according to the wall conditions. The maximum adjustment range is 5 cm. Then tighten the fixing screw (R).

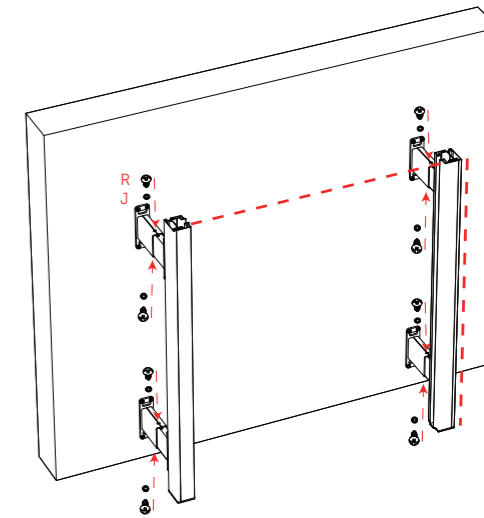
WARNING!

- For use with VARI Zip Screen only.
- Incorrect installation may cause the structure to come loose and result in injury to persons or damage to property.
- Must be mounted to a load-bearing substrate (wood/steel/concrete).
- Do not install in cladding or plaster only. Use recommended screws/bolts and ensure proper sizing for the substrate.
- Max weight load per bracket is 50 kgs.

